

Testreihe HEB 200 in HEB 240  
Stahlgüte S235JR

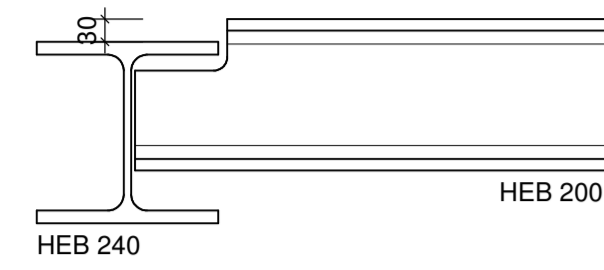

Testreihe HEB 200 in HEB 240  
Stahlgüte S235JR

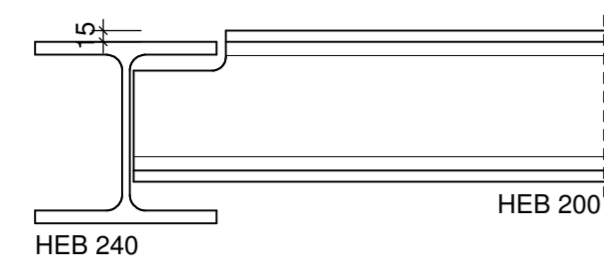

Testreihe HEB 200 in HEB 240  
Stahlgüte S235JR

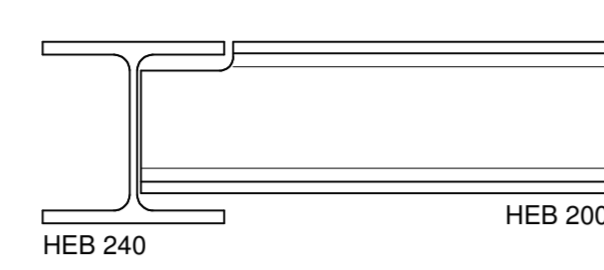

Testreihe HEB 200 in HEB 240  
Stahlgüte S235JR

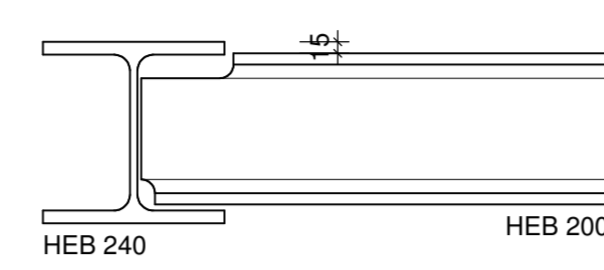

Testreihe HEB 200 in HEB 240  
Stahlgüte S235JR

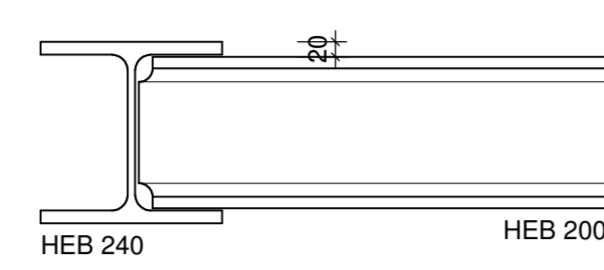

Testreihe HEB 200 in HEB 240  
Stahlgüte S235JR

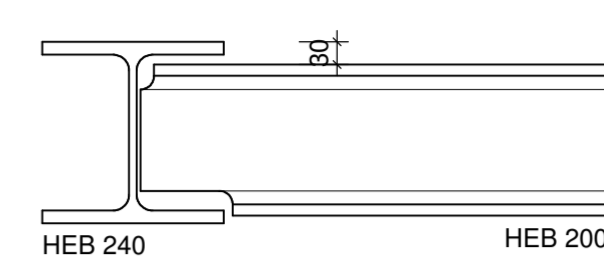

Testreihe HEB 200 in HEB 240  
Stahlgüte S235JR

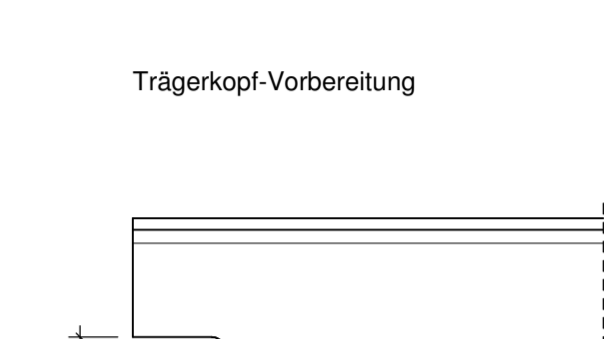
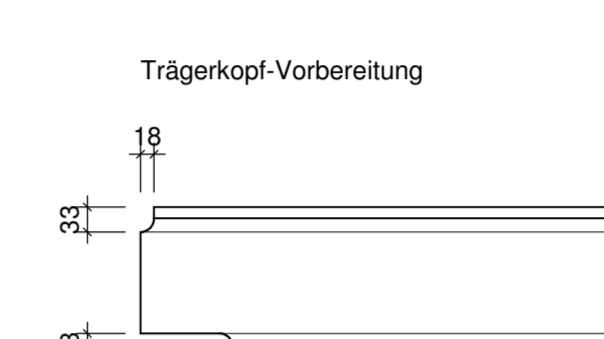
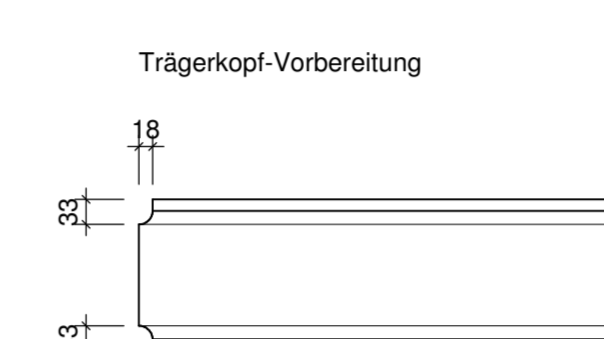
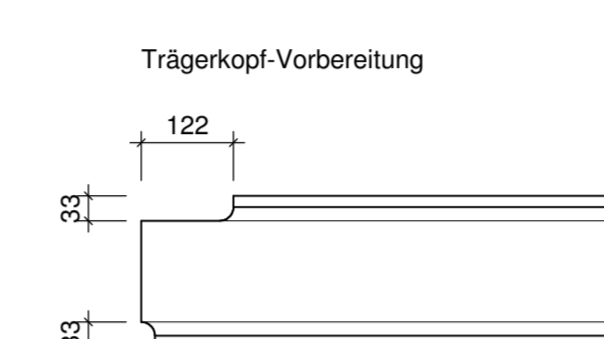
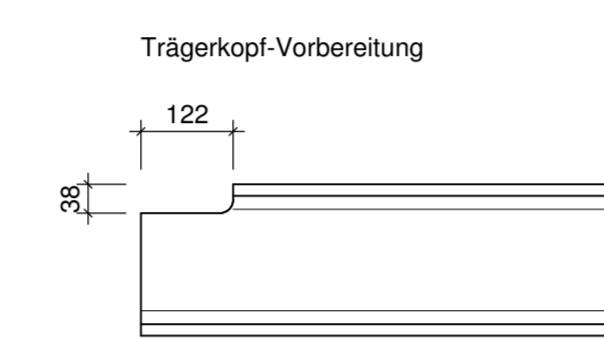
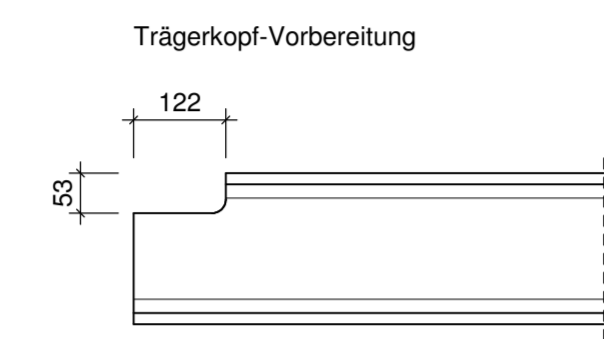
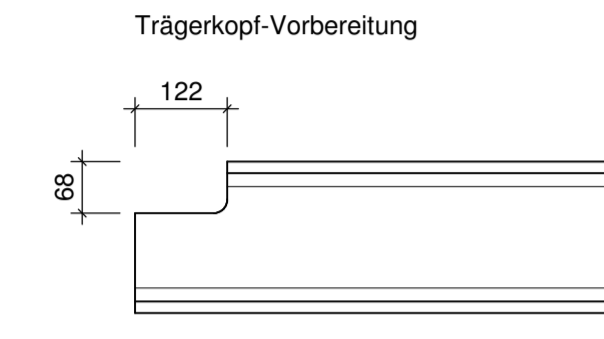
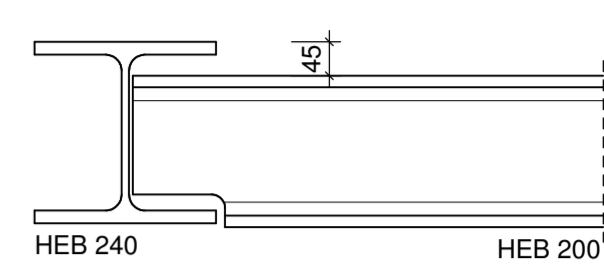

## Testreihe 1 für Stahlbau-Makro-24: Trägersausklinkung (Ausrundung) HEB 200 in HEB 240

Testreihe HEB 200 in HEB 240  
Stahlgüte S235JR

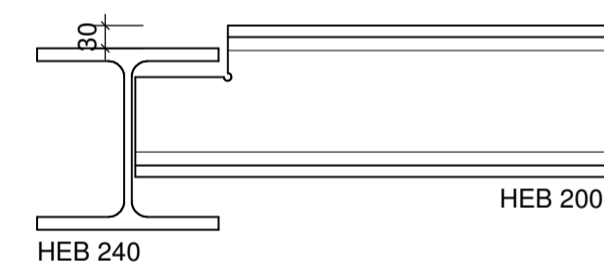

Testreihe HEB 200 in HEB 240  
Stahlgüte S235JR

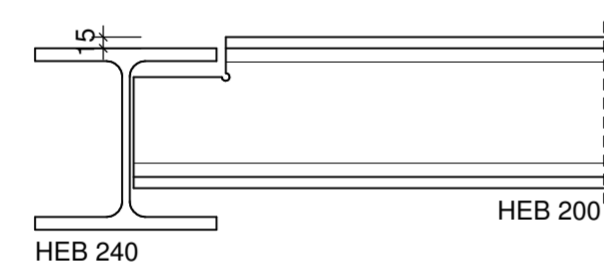

Testreihe HEB 200 in HEB 240  
Stahlgüte S235JR

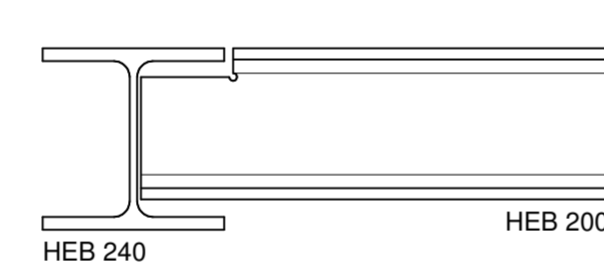

Testreihe HEB 200 in HEB 240  
Stahlgüte S235JR

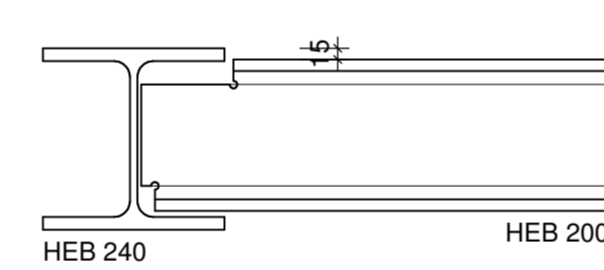

Testreihe HEB 200 in HEB 240  
Stahlgüte S235JR

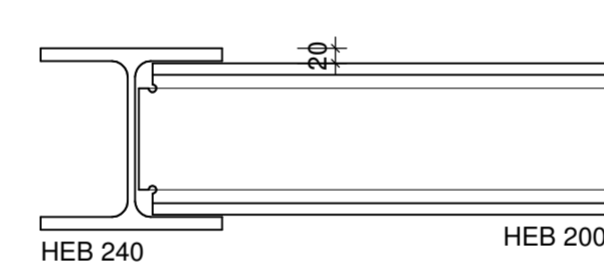

Testreihe HEB 200 in HEB 240  
Stahlgüte S235JR

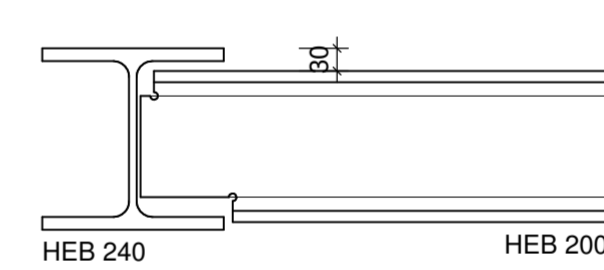

Testreihe HEB 200 in HEB 240  
Stahlgüte S235JR

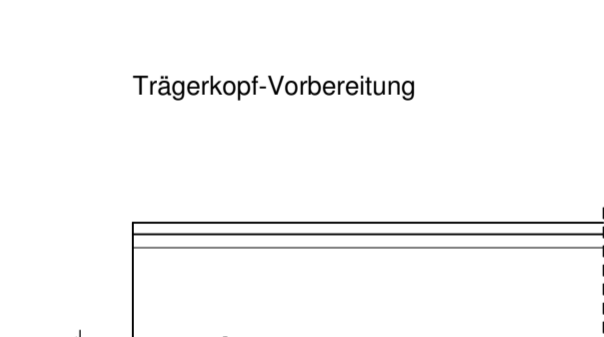
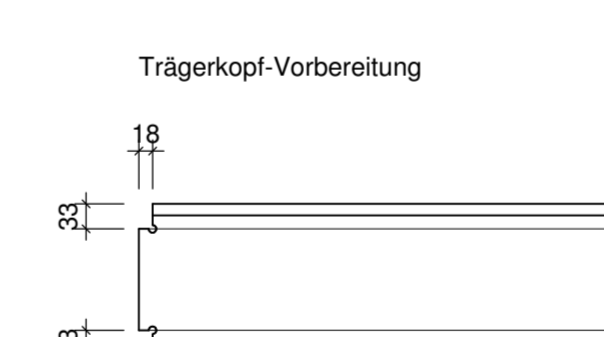
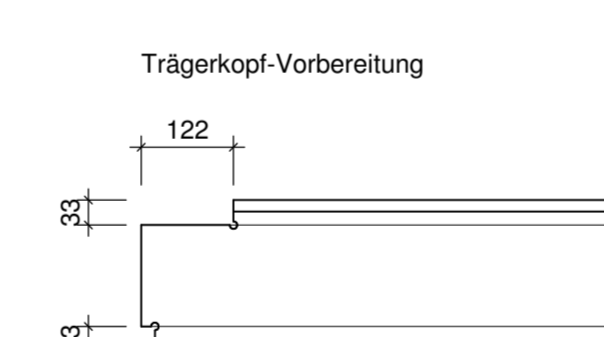
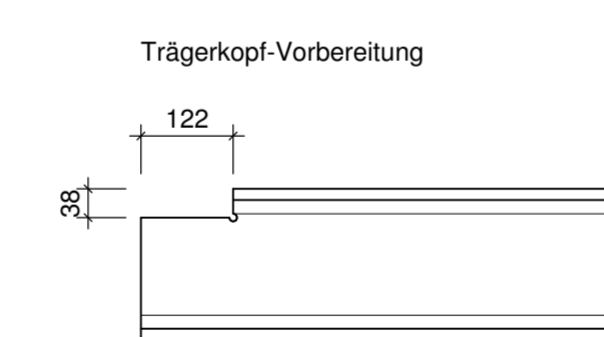
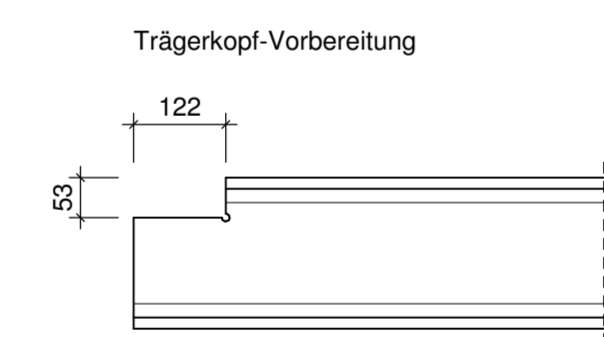
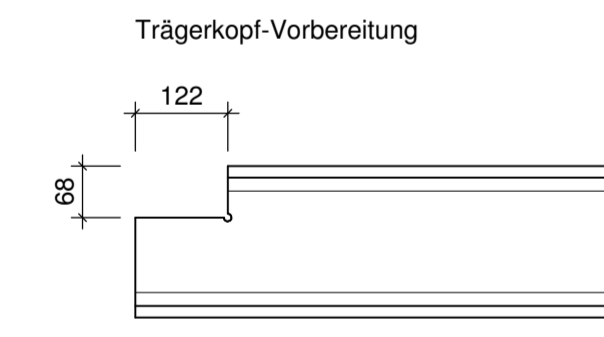
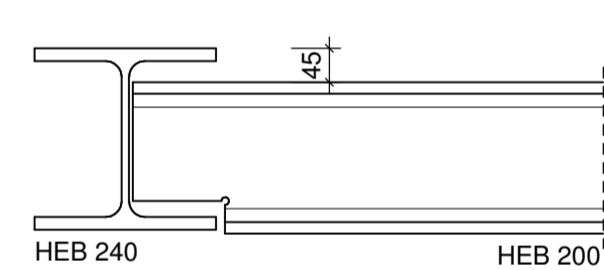

## Testreihe 2 für Stahlbau-Makro-24: Trägersausklinkung (mit Hilfsbohrung) HEB 200 in HEB 240

Index	Datum	Änderung
BAUHERR: Produktionsfirma GmbH in 64331 Weiterstadt / Industriestraße 17		
BAUVORHABEN: Neubau Verpackungcenter		
BAUTEIL: Testreihen HEB 200 in HEB 240		
<b>Ingenieurbüro für Baustatik</b> Dipl.-Ing. Klaus Nagel Prenzlauer Weg 4 64331 Weiterstadt	gezeichnet: Na.	Maßstab: 1:10
	geprüft:	Blattgröße: DIN A1
	Datum: 23.02.2014	Proj.-Nr.: 2014-1
	zu Zeichnung: S - 2.1	Zeichnungs-Nr.: S- 2.2
	Position: 30-49	